

Tender specification:

Oventrop bronze piston type spring assisted check valves PN 25, both ports female thread according to EN 10226 or DIN ISO 228.

Body made of bronze, inner parts made of brass, valve disc with FKM seal.

Function:

Oventrop piston type spring assisted check valves are suitable for horizontal and vertical installation in the pipework. The valve disc is spring assisted with an opening pressure of 40 mbar (~ 400 mm WG).

Piston type spring assisted check valves are not suitable for use on pulsating flow and must be installed with a minimum of 10 D (10 x nominal pipe diameter) of straight pipe behind the pump.

Application:

Central heating and cooling systems.

PN 25 for fluids: Water (-10 °C up to +120 °C), mineral, heating and hydraulic oils, diesel oil and other non-aggressive fluids between 0 °C and a maximum of 100 °C (the valid rules and standards for the use of these media may restrict the temperature range), PN 6 for air.

The piston type spring assisted check valves DN 10 to DN 20 are suitable for use with compression fittings, item no. 10271...

Size	k _{VS} value	Item no.
DN 10	2.5	1072003
DN 15	3.8	1072004
DN 20	6.0	1072006
DN 25	13.0	1072008
DN 32	17.0	1072010
DN 40	19.0	1072012
DN 50	30.5	1072016

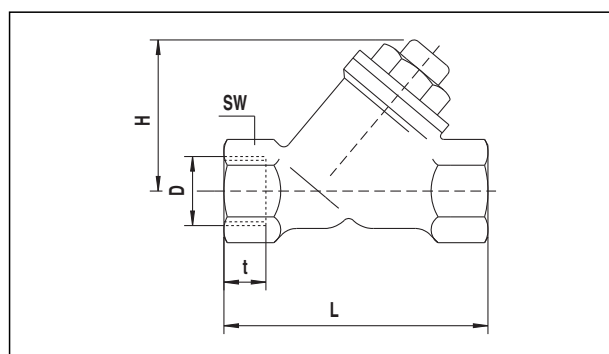

DN	D*	L	H	t	SW**
10	Rp 3/8	63.5	35	10.1	22
15	Rp 1/2	66	43	13.2	27
20	Rp 3/4	75	49	14.3	32
25	G 1	80	55	10.5	41
32	G 1 1/4	97	67	12.5	50
40	G 1 1/2	107	80	14.5	56
50	G 2	124	92	16.5	68

Dimensions

* Rp according to EN 10226

* G according to DIN ISO 228

** SW = spanner size

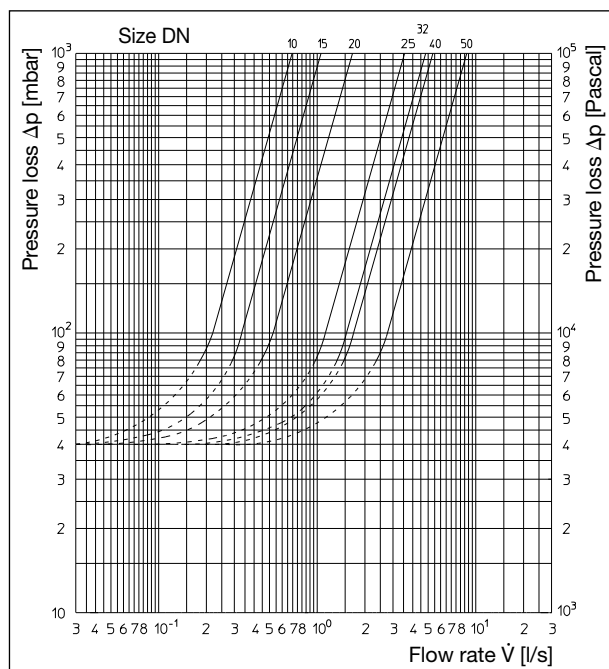

Flow chart

OVENTROP GmbH & Co. KG
Paul-Oventrop-Straße 1
D-59939 Olsberg, Germany
Phone +49 (0) 29 62 82-0
Fax +49 (0) 29 62 82-450
E-Mail mail@oventrop.de
Internet www.oventrop.de

For an overview of our global presence
visit www.oventrop.de.

Subject to technical modification without notice.

Product range 5
ti 178-EN/10/MW
Edition 2015